



Hampton Convention & Visitors Bureau
 1919 Commerce Drive, Suite 290, Hampton, Virginia 23666 • 800.487.8778 • 757.722.1222 • visithampton.com

MILEAGE TO HAMPTON, VA

Atlanta 541 miles Philadelphia 277 miles New York City 378 miles Washington, DC 180 miles
 Charlotte 240 miles Raleigh/Durham 200 miles Virginia Beach Oceanfront 25 miles Williamsburg 34 miles



The Hampton Roads Convention Center is located in Hampton, Virginia. The city's unofficial motto, "First from the sea, first to the stars" encapsulates more than 400 years of history that span the arrival of the first English-speaking settlers in North America to the training of NASA's Mercury Seven astronauts, the first Americans to fly into outer space.

In Hampton, your group will discover an array of attractions that range from the exciting shopping and dining district of Peninsula Town Center to the charming riverfront area of Downtown Hampton and the unique character of Phoebus.

Hampton occupies the center of Coastal Virginia, a vibrant collection of communities in the heart of the Mid-Atlantic region. Two-thirds of the population living on the East Coast can drive here in a day or less. Convention Center attendees enjoy convenient access to more than 200 significant attractions stretching from Williamsburg to Norfolk and Virginia Beach, all within a 30 minute drive.

Accommodations for guests attending events at the Hampton Roads Convention Center provide a wealth of options. A John Q. Hammons Embassy Suites is conveniently located adjacent to the center and connected by covered walkway. The hotel offers 295 two-bedroom suites, an award-winning restaurant, and Spa Botanica, among other excellent amenities. There are approximately 2,500 hotel rooms within close proximity of Hampton Roads Convention Center.

DRIVING DIRECTIONS

From I-64 Eastbound: Take Exit 263 (Mercury Blvd./James River Bridge).

Follow far right overpass leading to Hampton Coliseum; turn right onto Coliseum Drive and go approximately ¼ mile to the HRCC.

From I-64 Westbound: Take Exit 263-B (W. Mercury Blvd./Hampton Coliseum).

Follow off ramp to immediate intersection with Coliseum Drive; turn right onto Coliseum Drive and go approximately ¼ mile to the HRCC.

Hampton Roads Convention Center
 1610 Coliseum Drive Hampton, VA 23666 • 757.315.1610 • thehrcc.com



A SETTING FOR ALL Occasions.

White sails above the entrance to the Hampton Roads Convention Center provide a visual reminder of the first settlers to reach this area by sea over 400 years ago. Today's visitors to this impressive facility travel here for a variety of purposes—to share ideas, to compete in athletic competitions, to introduce new products, just to name a few—in surroundings as inspirational as they are functional.

A model of flexibility, the center's 344,000 square feet and 35 event spaces contain three exhibit halls, a multi-configurable grand ballroom, a conference center with private access and an enormous amount of pre-function area. Attendees gathered for special affairs on the outdoor terrace, with sails above and fountains below, might imagine themselves standing on the deck of an elegant ship sailing across the sea.

Ease of use and connectivity in the Hampton Roads Convention Center please meeting planners and attendees alike. Throughout the facility there is wireless Internet access and data ports are located in meeting rooms and exhibit spaces. Eleven loading dock bays and dedicated elephant doors for each exhibit hall make life easy for those staging large shows. With audiovisual services provided by PSAV Presentation Services® and management by SMG, you can count on our experienced, professional staff to keep everything shipshape at your event.

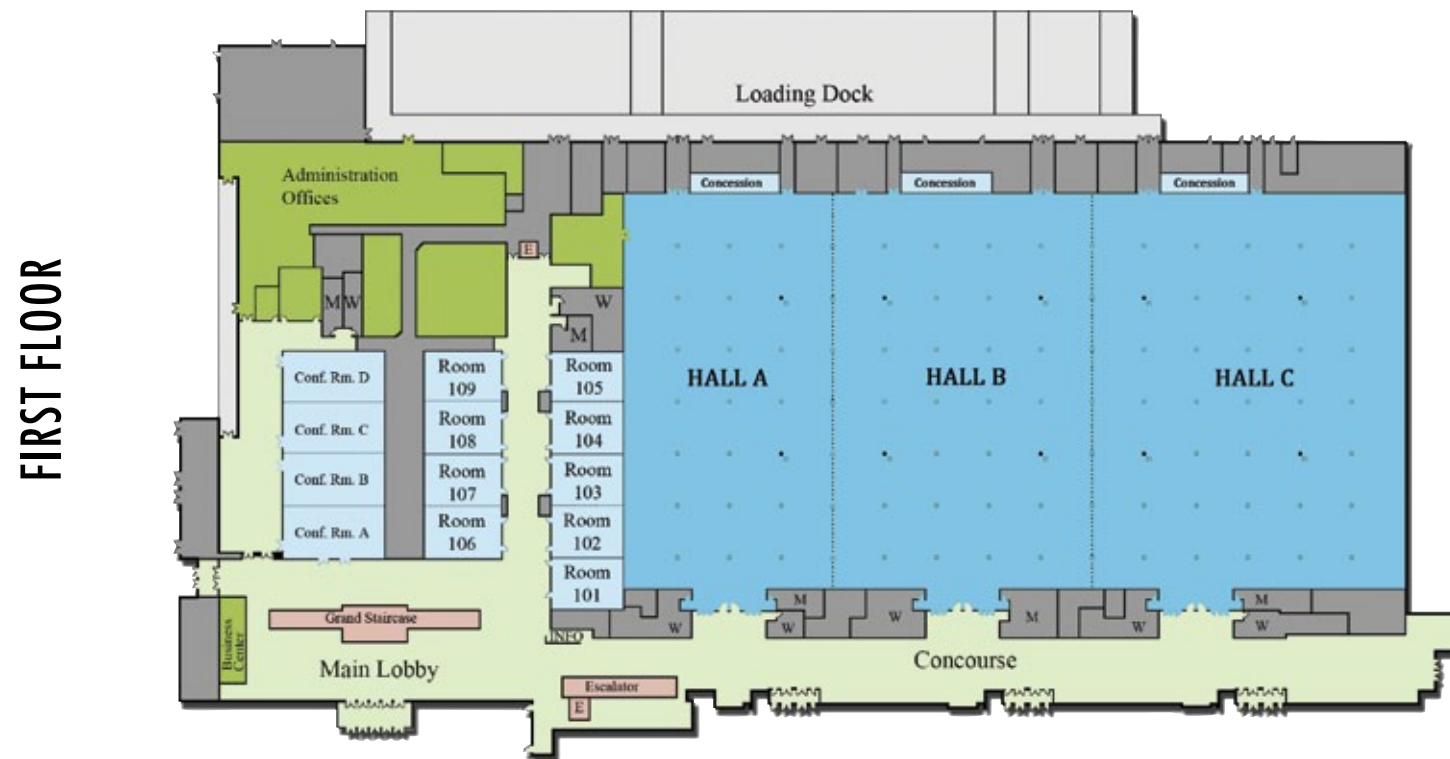
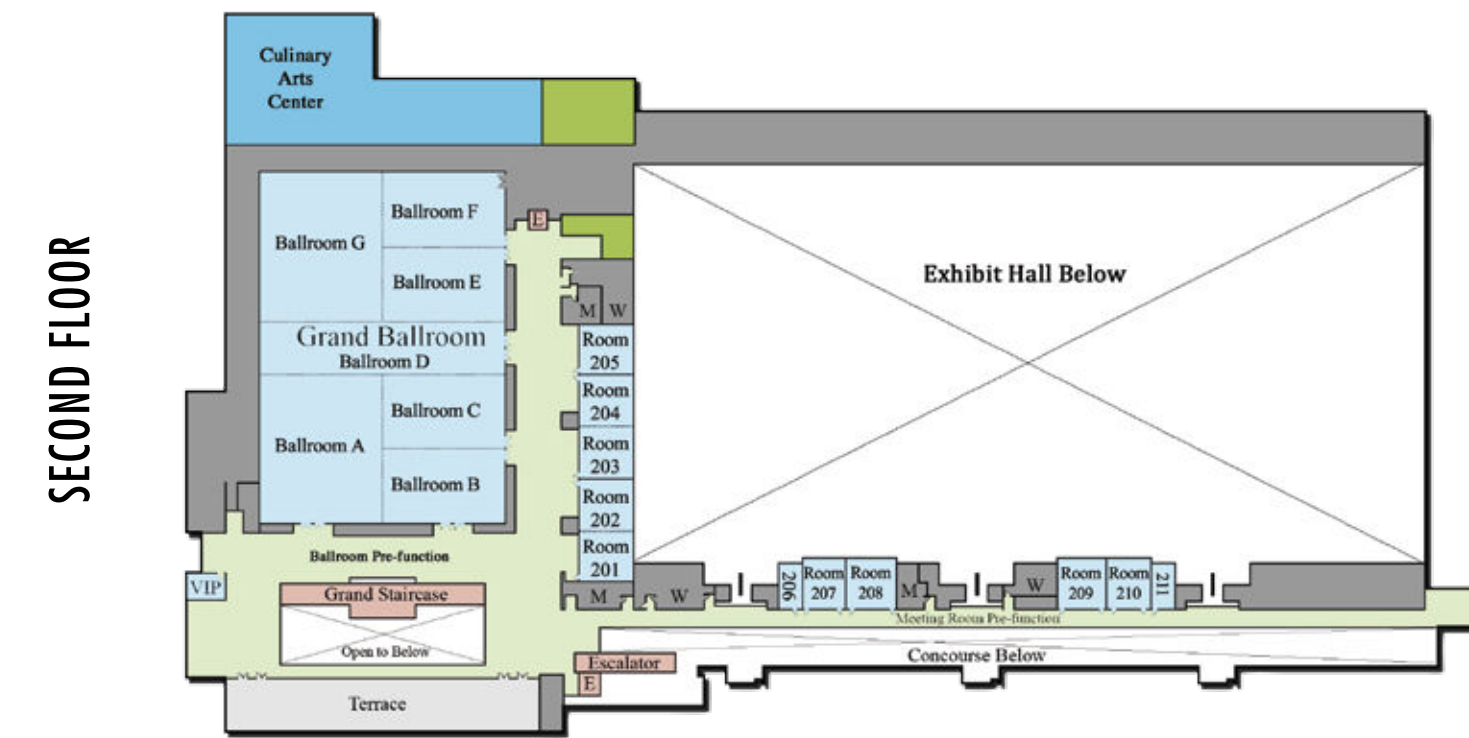

Exhibit Hall Total sq. ft. 102,600								
Room	Size	Sq. Ft.	Ceiling	10x10	Theater	Classroom	Banquet	Reception
Hall A	228' x 120'	27,360	30'	144	2,500	1,360	1,520	2,750
Hall AB	228' x 270'	61,560	30'	325	5,300	3,070	3,740	5,830
Hall ABC	228' x 450'	102,600	30'	543	9,000	5,130	5,700	9,900
Hall B	228' x 150'	34,200	30'	184	3,000	1,710	2,020	3,900
Hall BC	228' x 330'	75,240	30'	402	6,400	3,760	4,620	7,040
Hall C	228' x 180'	41,040	30'	221	3,800	2,050	2,360	4,180

Conference Room Total sq. ft. 6,962							
Room	Size	Sq. Ft.	Ceiling	Theater	Classroom	Banquet	Reception
Conference Room A	58'6" x 29'9"	1,740	14'	170	80	100	220
Conference Room AB	58'6" x 59'6"	3,481	14'	340	170	200	460
Conference Room ABC	58'6" x 89'3"	5,221	14'	520	260	300	710
Conference Room ABCD	58'6" x 119'	6,962	14'	690	340	400	990
Conference Room B	58'6" x 29'9"	1,740	14'	170	80	100	220
Conference Room BC	58'6" x 59'6"	3,481	14'	340	170	200	460
Conference Room BCD	58'6" x 89'3"	5,221	14'	520	260	300	710
Conference Room C	58'6" x 29'9"	1,740	14'	170	80	100	220
Conference CD	58'6" x 59'6"	3,481	14'	340	170	200	460
Conference Room D	58'6" x 29'9"	1,740	14'	170	80	100	220

1st Floor Meeting Rooms							
Room	Size	Sq. Ft.	Ceiling	Theater	Classroom	Banquet	Reception
101	40' x 29'6"	1,180	12'	110	50	60	140
102	40' x 29'9"	1,190	12'	110	50	60	140
102-103	40' x 59'6"	2,380	12'	230	110	150	270
103	40' x 29'9"	1,190	12'	110	50	60	140
104	40' x 29'9"	1,190	12'	110	50	60	140
104-105	40' x 59'6"	2,380	12'	230	110	150	270
105	40' x 29'9"	1,190	12'	110	50	60	140
106	45' x 29'9"	1,339	12'	130	60	80	160
106-107	45' x 59'6"	2,678	12'	260	130	170	320
107	45' x 29'9"	1,339	12'	130	60	80	160
108	45' x 29'9"	1,339	12'	130	60	80	160
108-109	45' x 59'6"	2,678	12'	260	130	170	320
109	45' x 29'9"	1,339	12'	130	60	80	160



Grand Ballroom Total sq. ft. 27,907							
Room	Size	Sq. Ft.	Ceiling	Theater	Classroom	Banquet	Reception
Ballroom A	70' x 84'8"	5,927	24'	590	290	360	770
Ballroom ABC	140' x 84'6"	11,830	24'	1,180	590	720	1,450
Ballroom ABCD	140' x 114'8"	16,053	24'	1,600	800	1070	2,150
Ballroom ABCDEFG	140' x 199'4"	27,907	24'	2,790	1,390	1,860	3,890
Ballroom B	70' x 42'	2,940	24'	290	140	180	350
Ballroom BC	70' x 84'8"	5,927	24'	590	290	360	770
Ballroom C	70' x 42'	2,940	24'	290	140	180	350
Ballroom G	70' x 84'8"	5,927	24'	590	290	360	770
Ballroom EFG	140' x 84'6"	11,830	24'	1,180	590	720	1,450
Ballroom DEFG	140' x 114'8"	16,053	24'	1,600	800	1080	2,150
Ballroom E	70' x 42'	2,940	24'	290	140	180	350
Ballroom EF	70' x 84'8"	5,927	24'	590	290	360	770
Ballroom F	70' x 42'	2,940	24'	290	140	180	350

2nd Floor Meeting Rooms Total sq. ft. 7,910							
Room	Size	Sq. Ft.	Ceiling	Theater	Classroom	Banquet	Reception
201	29'6" x 29'9"	878	13'	80	40	50	90
201-202	59' x 29'9"	1,755	13'	170	80	100	210
202	29'6" x 29'9"	878	13'	80	40	50	90
203	29'6" x 29'9"	878	13'	80	40	100	90
203-204	59' x 29'9"	1,755	13'	170	80	50	210
204	29'6" x 29'9"	878	13'	80	40	50	90
205	28'3" x 29'9"	840	13'	80	40	50	90
206	13'9" x 23'6"	323	13'	30	10	20	30
207	24' x 28'	672	13'	60	30	40	60
208	28' x 28'	784	13'	70	40	50	70
209	28' x 28'	784	13'	70	40	50	70
210	24' x 28'	672	13'	60	30	40	60
211	13'9" x 23'6"	323	13'	30	10	20	30

NOTE: Room capacity numbers are for general reference only. They are based on maximum seating without space allowance for head tables, risers, audio visual or any other equipment.